

NOTE:

1. ALL WORK IS TO BE COMPLETED TO A STANDARD ACCEPTABLE TO THE TDC ENGINEERING MANAGER, THE PROPERTY OWNER AND JONES & STANGER LTD.
2. ALL WORKS ARE TO BE COMPLETED IN STRICT ACCORDANCE WITH THE TASMAN DISTRICT COUNCIL ENGINEERING STANDARDS 2013.
3. THE CONTRACTOR SHALL INDEMNIFY THE OWNER AGAINST ALL AND ANY CLAIMS THAT MAY ARISE FROM THE CONSTRUCTION WORKS.
4. IT IS THE CONTRACTORS RESPONSIBILITY TO ENSURE THAT ALL EXISTING SERVICES ARE LOCATED PRIOR TO COMMENCEMENT OF WORK AND ARE PROTECTED DURING THE CONSTRUCTION WORKS.
5. ALL EARTHWORKS TO BE COMPLETED IN ACCORDANCE WITH RM150895. EROSION & SEDIMENT CONTROL PLAN TO BE COMPLETED BY CONTRACTOR AND APPROVED BY TDC BEFORE WORKS COMMENCE.
6. CONTRACTOR TO EXCAVATE NEW COMMON UTILITY SERVICE TRENCH 700mm WIDE BY 900mm DEEP. REQUIRE 150mm SAND BASE. UTILITY DESIGN SERVICE PLAN WILL BE PROVIDED, WHEN AVAILABLE TO TDC & THE CONTRACTOR FOR THEIR INFORMATION
7. ALL NEW & EXISTING WATER TABLES SHOWN ON PLAN FACE ARE TO BE SHAPED TO GO INTO CULVERTS
8. ALL HEIGHTS ARE IN TERMS OF NZVD 2016 HEIGHT DATUM.

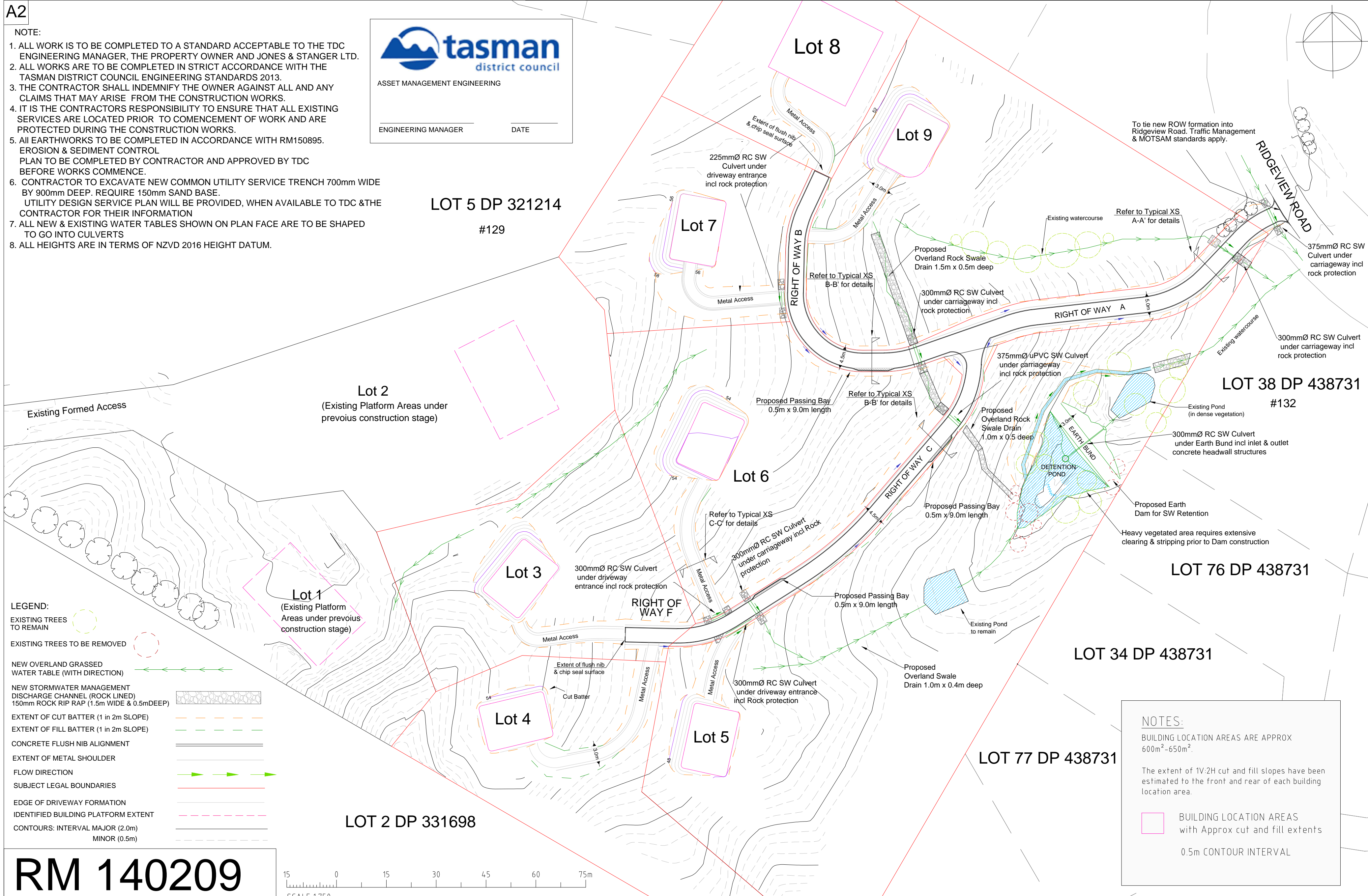
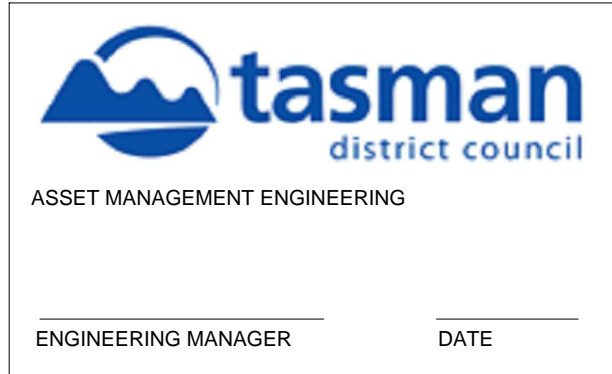

**LEGEND:**

- EXISTING TREES TO REMAIN (Green circle)
- EXISTING TREES TO BE REMOVED (Red circle)
- NEW OVERLAND GRASSED WATER TABLE (WITH DIRECTION) (Green arrow)
- NEW STORMWATER MANAGEMENT DISCHARGE CHANNEL (ROCK LINED) 150mm ROCK RIP RAP (1.5m WIDE & 0.5m DEEP) (Grey hatched)
- EXTENT OF CUT BATTER (1 in 2m SLOPE) (Dashed orange line)
- EXTENT OF FILL BATTER (1 in 2m SLOPE) (Dashed green line)
- CONCRETE FLUSH NIB ALIGNMENT (Double line)
- EXTENT OF METAL SHOULDER (Single line)
- FLOW DIRECTION (Green arrow)
- SUBJECT LEGAL BOUNDARIES (Red line)
- EDGE OF DRIVEWAY FORMATION (Dashed pink line)
- IDENTIFIED BUILDING PLATFORM EXTENT (Dashed pink line)
- CONTOURS: INTERVAL MAJOR (2.0m) (Dashed black line)
- MINOR (0.5m) (Dotted black line)

**NOTES:**

BUILDING LOCATION AREAS ARE APPROX 600m<sup>2</sup> - 650m<sup>2</sup>.

The extent of 1V:2H cut and fill slopes have been estimated to the front and rear of each building location area.

BUILDING LOCATION AREAS with Approx cut and fill extents

0.5m CONTOUR INTERVAL

**RM 140209**

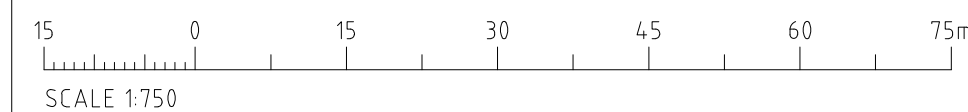

No.	Date	Revision Details	By	Ver.	App.

**JONES & STANGER LTD**  
Registered Surveyors & Planners

104 Collingwood Street  
PO Box 562  
NELSON

email: info@jasl.nz  
Ph (03) 548-2833

Client: **ECOLOGY LIMITED**  
131 MAISEY ROAD  
REDWOOD VALLEY

Project: **ECOLOGY - STAGES 2 & 3  
SUBDIVISION DEVELOPMENT**

Drawn	Signed	Date
MJR		25/4/18
Designed		Date
Verified AS		Date
Approved		Date

Drawing Title: **OVERALL LAYOUT PLAN  
EXTENT OF CIVIL CONSTRUCTION**

Project No.	3763
Scale	1:750 @ A2
Drawing No.	3763 - A
Rev.	B